

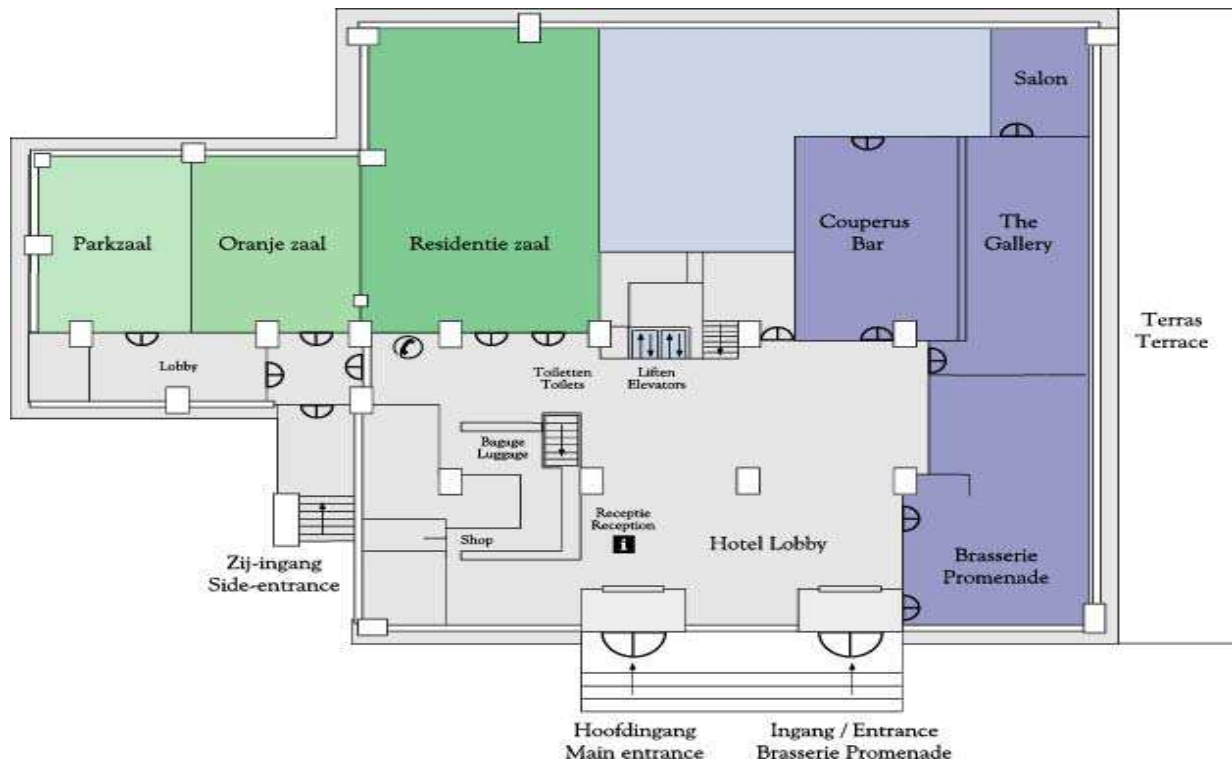

Floorplan groundfloor

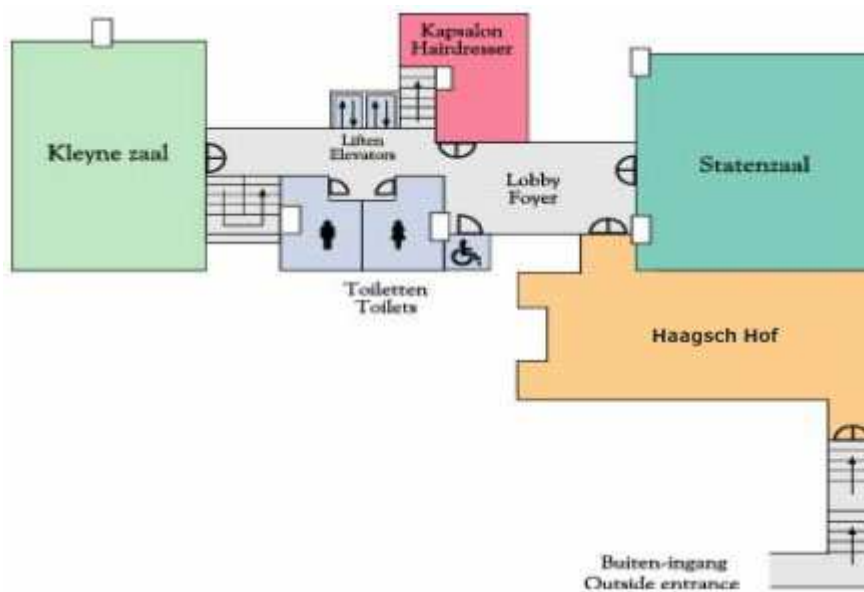

Floorplan souterrain



**Dimensions & capacities of the function-rooms**

Function-rooms	A	B	C	D	E	F	G	F+G	H	I	B+C	A+B	A+B+C
Hight	3.2	3.2	3.2	2.5	2.5	3.2	3.2	3.2	2.5	2.5	3.2	3.2	3.2
Length	19.5	11	11	13	12	8	13	21	7	16	15	-	-
Width	12	7.5	7.5	10	8	6	10	8.5	3.5	7	11	-	-
Sq.M²	234	82.5	82.5	130	96	48	130	178	24.5	112	165	316	399
Daylight	J	J	J	N	N	J	J	J	J	N	J	J	J
U-shape	54	25	25	34	25	-	-	-	-	-	50	58	92
Hollow square	70	38	38	40	32	-	-	-	10	-	64	68	102
Classroom	100	42	42	68	40	-	-	-	-	-	84	120	160
Cabaret	190	50	50	80	45	-	-	-	-	-	125	200	250
Theatre	240	65	65	100	55	-	-	-	-	-	145	310	400
Dinner- Lunch	150	50	50	80	40	30	80	120	-	60	100	200	250
Reception	300	75	75	125	75	50	175	225	-	100	200	450	600

- Function-rooms A and B and C can be connected.
- Function-rooms F and G can be connected.
- Dimensions in metres.
- Capacities and room-settings in number of persons.

- A.** Residentie zaal
B. Oranje zaal
C. Parkzaal
D. Statenzaal

- E.** Kleyne zaal
F. Salon
G. The Gallery
H. Executive Boardroom
I. Haagsch Hof

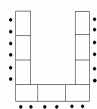
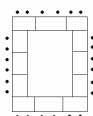
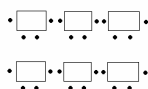
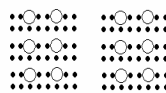
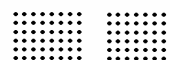
**U-vorm****Carré****School****Cabaret****Theater**